

SPECIFICATIONS

HOUSING MATERIAL/COLOR

NYLON 66/BLACK

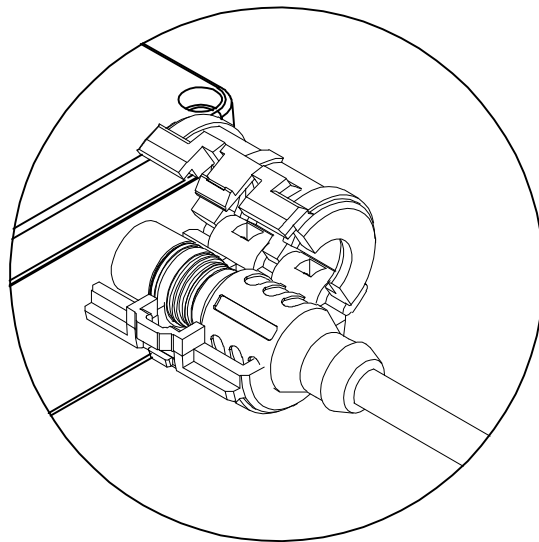

TO INSTALL LOCKOUT DEVICE, PLACE AROUND CORDSET END AND CLOSE UNTIL CONNECTOR SNAPS CLOSED. REFERENCE DIAGRAM OF CONNECTOR.

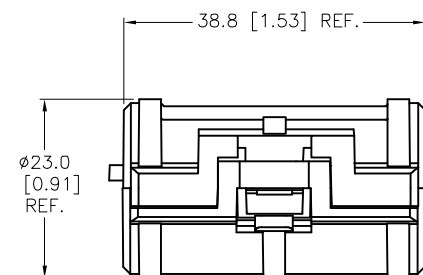

LOCKOUT DEVICE FITS ALL STRAIGHT TURCK EUROFAST CONNECTORS. (RKC, RSC, RKS, RSS, RKSX, RSSX)

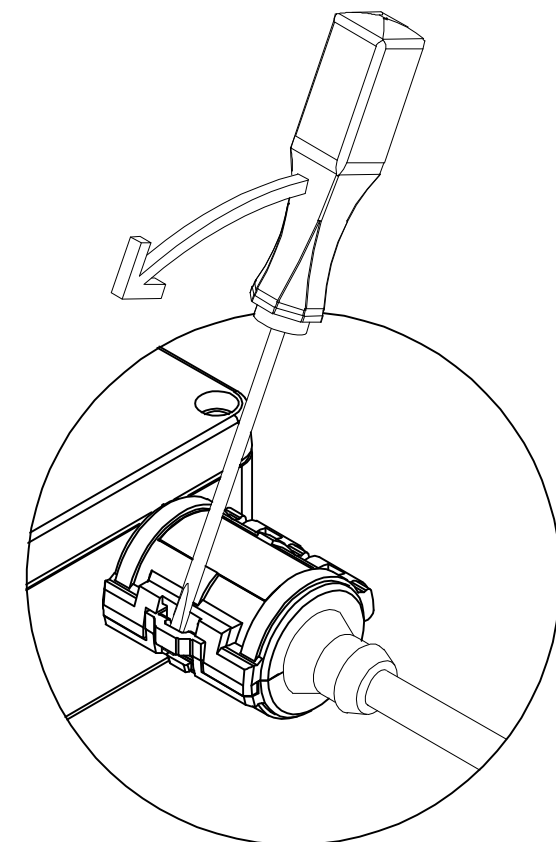

TO REMOVE LOCKOUT DEVICE, INSERT SMALL SCREWDRIVER INTO LOCKING GROOVE AS SHOWN IN PICTURE. ROTATE SCREWDRIVER IN DIRECTION SHOWN UNTIL LOCKING DEVICE RELEASES.

SOURCE DRAWING - FOR REFERENCE ONLY

RELATED DOCUMENTS		3RD ANGLE PROJECTION		THIS DRAWING IS CONFIDENTIAL AND THE PROPERTY OF TURCK INC. USE OF THIS DOCUMENT WITHOUT WRITTEN PERMISSION IS PROHIBITED.		3000 CAMPUS DRIVE MINNEAPOLIS, MN 55441 1-800-544-7769 (763) 553-7300 (763) 553-0708 fax www.turck.us	
1. 9-RDV-166 2. 3. 4.				DRFT RDS		DATE 12/29/04	
MATERIAL		ALL DIMENSIONS DISPLAYED ON THIS DRAWING ARE FOR REFERENCE ONLY		APVD		SCALE 1=1.0	
FINISH		CONTACT TURCK FOR MORE INFORMATION		UNIT OF MEASUREMENT MILLIMETERS		DESCRIPTION LOCK-EURO-C (10/BAG)	
				DO NOT SCALE THIS DRAWING		IDENTIFICATION NO. A0886	
B UPDATE TO NEW EURO-LOCK PARTS		RDS 05/04/16		54524		REV B	
REV DESCRIPTION		BY DATE		ECO NO.		FILE: A0886	
						SHEET 1 OF 1	